



# Application

Customized vehicle fan system

# VEHICLES EQUIPMENT

Energy Saving | High Speed | Low Noise





## ABOUT COOLTRON

### Cooltron Fans

Customer satisfaction is always Cooltron's number one priority. Cooltron values customers' opinions and suggestions, and always tries hard to improve and surpass customer's expectation in all aspects, not only in designs and manufacturing, but also in sales, marketing, logistics, and after services. Cooltron believes only satisfied customers will guarantee long term business and relationship.

### Company Overview

Since the incept in California USA in 1999, Cooltron has been designing, manufacturing, and supplying to the worldwide thermal management markets broad lines of fans, blowers, heat sinks, parts and accessories for over 19 years. With devotion to technologies innovation, dedication to customization, strives to best product cost/performance and customer satisfaction, Cooltron has won reputation from global customers in a great variety of application markets such as Telecom & Networking, Power Supply, Industrial, Medical.

### Integral & Complete Total Thermal Solutions

Cooltron provides more integral and complete Total Thermal Solutions, starting from Initial Design Cycle, CFD Modeling & Thermal Simulation, Prototype, Pilot Run, Mass Production, Logistic, till After Services for customers' one-stop shopping conveniences.

### Beyond Designs & Manufacturing

In addition to designs and manufacturing, Cooltron also consults its customers with competitive sales & marketing strategies to work out the most optimum thermal product that will meet customers' specification requirements and the market positioning as well.

### Mission Statement

Cooltron is committed to product excellence and has been continuously striving for innovation and incorporation of new Thermal Management technologies, adoption of new production techniques and materials that help Cooltron make better thermal performance, more energy efficient and longer life time fans, blowers, and heat sinks.

## Electric Vehicle Charger

FD/FA Axial Fan: 40x28 / 80x38 / 172x51 / 222 x 60 mm



Customization available.



# VEHICLES EQUIPMENT

Energy Saving | High Speed | Low Noise

## Seat Cushion

FD Axial Fan: 50×15 / 60×20 / 60×25 mm

## Fragrance

FD Axial Fan: 25×10 / 30×10 / 40×10 mm

## Car Refrigerator

FD Axial Fan: 92 x 25 mm

# DC AXIAL FAN 25x25x10mm



Housing/Blade: Thermoplastic PBT, UL 94V-0  
 Insulation Resistance: 10MΩ, 500VDC/min between bare wire and frame  
 Dielectric Strength: 5mA max. 500VAC/min between bare wire and frame  
 Operation Temperature: -10°C~70°C(Humidity 35%-85%RH)  
 Storage Temperature: -40°C~85°C(Humidity 35%-85%RH)  
 Lead Wire: UL Type #28 AWG  
 Weight: 7 g      Packing: 400PCS/CTN



DC Axial Fans

Model Number	Voltage (VDC)	Op.Voltage (VDC)	Air Flow (CFM)	Static Pres. (mm-H <sub>2</sub> O)	Noise (dBA)	Speed (RPM)	Current (mA)	Power (W)	Available Bearing	Curves
FD2510B05W3-61	★▲ 5	4.0~5.75	1.40	2.50	18.70	7,000	80	0.40	B,S	①
FD2510B05W5-61	★▲ 5	4.0~5.75	2.30	4.70	22.70	10,000	120	0.60	B,S	②
FD2510B05W7-61	★▲ 5	4.0~5.75	3.00	8.20	29.60	13,000	160	0.80	B,S	③
FD2510B12W3-61	★▲ 12	6.0~13.8	1.40	2.50	18.70	7,000	60	0.72	B,S	①
FD2510B12W5-61	★▲ 12	6.0~13.8	2.30	4.70	22.70	10,000	80	0.96	B,S	②
FD2510B12W7-61	★▲ 12	6.0~13.8	3.00	8.20	29.60	13,000	100	1.20	B,S	③

- For "Sleeve" bearing version, change the "B" in the model number to "S" respectively.
- If model depicts "★", auto restart protection function built in.
- If model depicts "▲", polarity protection function built in.

Specifications are subject to change without notice

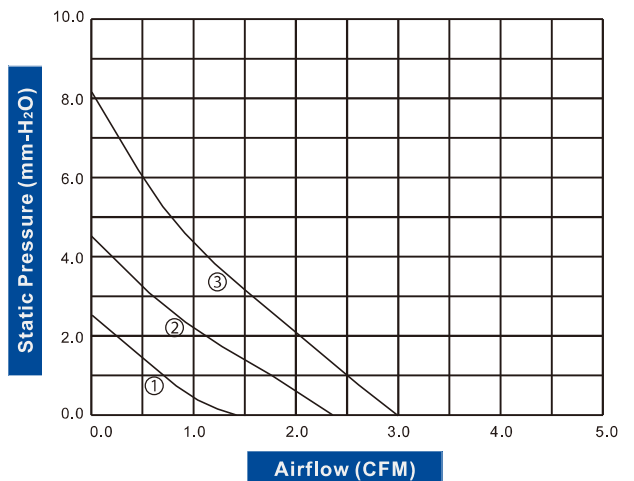
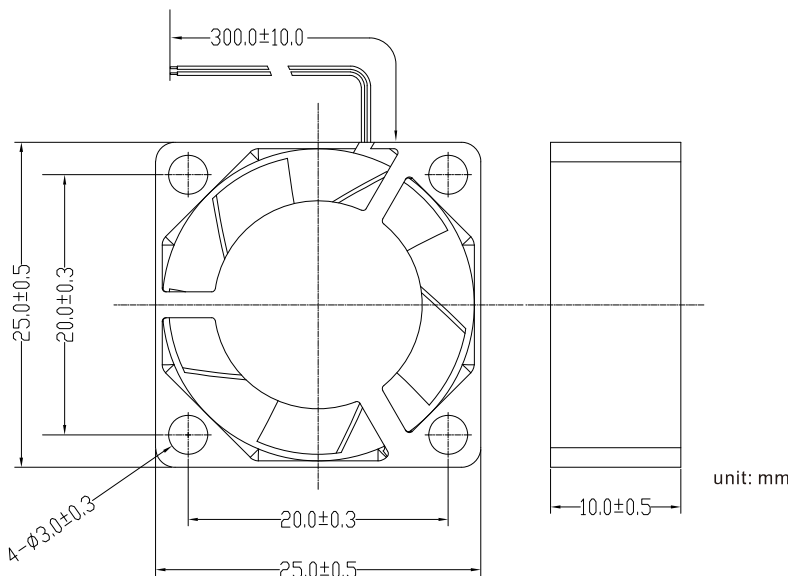

# DC AXIAL FAN 30x30x10mm



Housing/Blade: Thermoplastic PBT, UL 94V-0  
 Insulation Resistance: 10MΩ, 500VDC/min between bare wire and frame  
 Dielectric Strength: 5mA max. 500VAC/min between bare wire and frame  
 Operation Temperature: -10°C~70°C(Humidity 35%-85%RH)  
 Storage Temperature: -40°C~85°C(Humidity 35%-85%RH)  
 Lead Wire: UL Type #28 AWG  
 Weight: 8.5 g      Packing: 1200PCS/CTN



Model Number		Voltage (VDC)	Op.Voltage (VDC)	Air Flow (CFM)	Static Pres. (mm-H <sub>2</sub> O)	Noise (dBA)	Speed (RPM)	Current (mA)	Power (W)	Available Bearing	Curves
FD3010B05W3-61	★▲	5	4.0~5.75	3.20	2.80	22.70	7,000	120	0.60	B,S	①
FD3010B05W5-61	★▲	5	4.0~5.75	4.40	4.40	26.60	9,000	140	0.70	B,S	②
FD3010B05W7-61	★▲	5	4.0~5.75	5.30	6.00	31.50	11,000	200	1.00	B,S	③
FD3010B12W3-61	★▲	12	6.0~13.8	3.20	2.80	22.70	7,000	60	0.72	B,S	①
FD3010B12W5-61	★▲	12	6.0~13.8	4.40	4.40	26.60	9,000	90	1.08	B,S	②
FD3010B12W7-61	★▲	12	6.0~13.8	5.30	6.00	31.50	11,000	100	1.20	B,S	③

- For "Sleeve" bearing version, change the "B" in the model number to "S" respectively.
- If model depicts "★", auto restart protection function built in.
- If model depicts "▲", polarity protection function built in.

Specifications are subject to change without notice

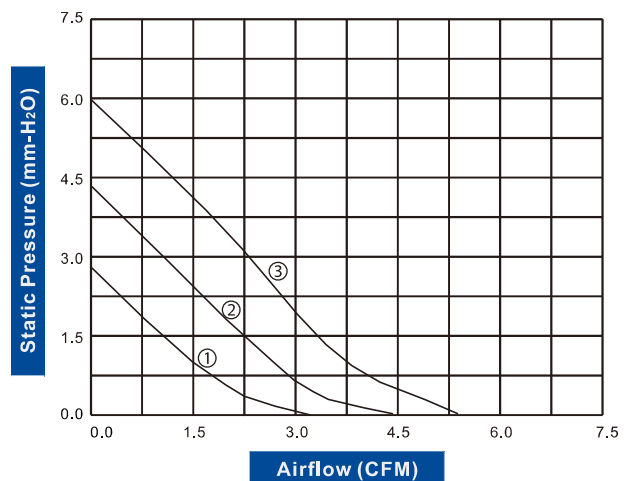
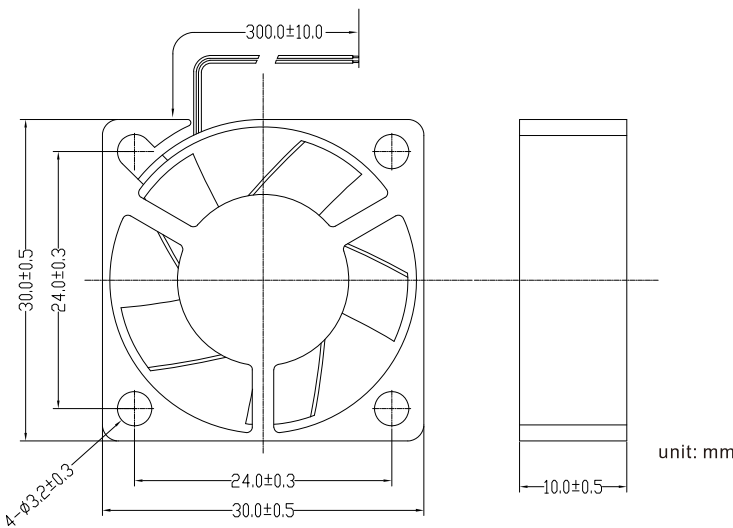

# DC AXIAL FAN 40x40x10mm



Housing/Blade: Thermalplastic PBT, UL 94V-0  
 Insulation Resistance: 10M $\Omega$ , 500VDC/min between bare wire and frame  
 Dielectric Strength: 5mA max. 500VAC/min between bare wire and frame  
 Operation Temperature: -10°C~70°C(Humidity 35%-85%RH)  
 Storage Temperature: -40°C~80°C(Humidity 35%-85%RH)  
 Lead Wire: UL Type #26 AWG  
 Weight: 16 g      Packing: 400PCS/CTN



Model Number	Voltage (VDC)	Op.Voltage (VDC)	Air Flow (CFM)	Static Pres. (mm-H <sub>2</sub> O)	Noise (dBA)	Speed (RPM)	Current (mA)	Power (W)	Available Bearing	Curves
FD4010B05W3-61B ★▲	5	3.5~5.75	5.70	1.70	24.60	4,500	130	0.65	B,S	①
FD4010B05W5-61B ★▲	5	3.5~5.75	7.00	2.60	27.60	5,500	160	0.80	B,S	②
FD4010B05W7-61B ★▲	5	3.5~5.75	8.70	3.90	31.50	6,500	200	1.00	B,S	③
FD4010B12W3-61B ★▲	12	7.0~13.8	5.70	1.70	24.60	4,500	60	0.72	B,S	①
FD4010B12W5-61B ★▲	12	6.0~13.8	7.00	2.60	27.60	5,500	70	0.84	B,S	②
FD4010B12W7-61B ★▲	12	6.0~13.8	8.70	3.90	31.50	6,500	90	1.08	B,S	③
FD4010B24W3-61B ★▲	24	16.0~27.6	5.70	1.70	24.60	4,500	50	1.20	B,S	①
FD4010B24W5-61B ★▲	24	12.0~27.6	7.00	2.60	27.60	5,500	60	1.44	B,S	②
FD4010B24W7-61B ★▲	24	12.0~27.6	8.70	3.90	31.50	6,500	90	2.16	B,S	③

- For "Sleeve" bearing version, change the "B" in the model number to "S" respectively.
- If model depicts "★", auto restart protection function built in.
- If model depicts "▲", polarity protection function built in.

Specifications are subject to change without notice

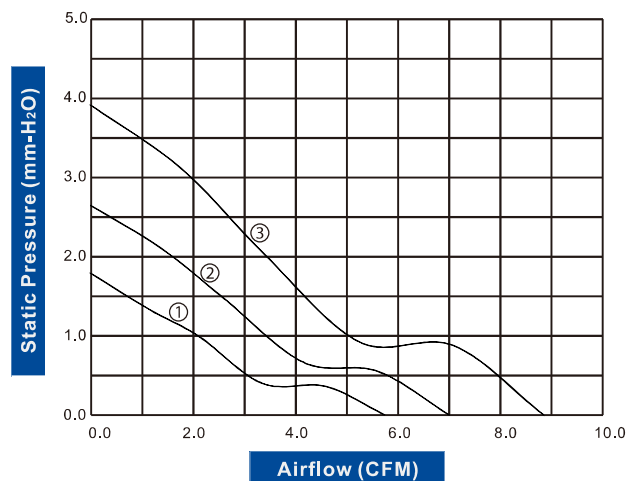
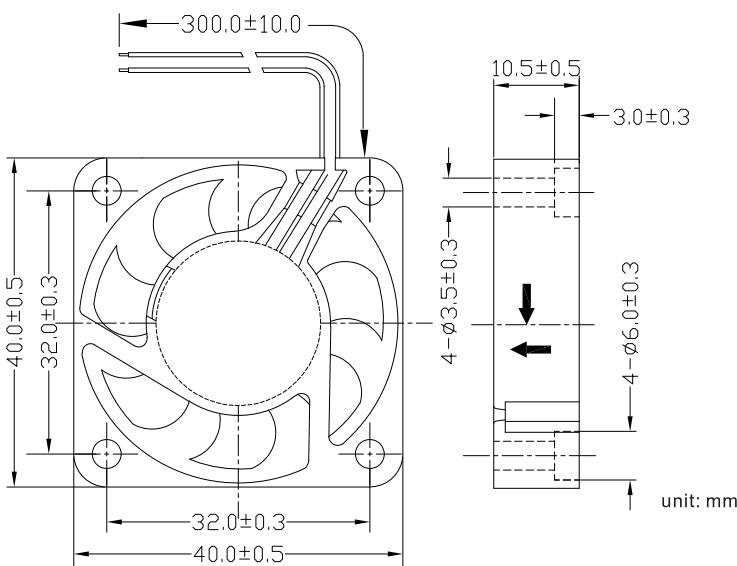

# DC AXIAL FAN 40x40x28mm



Housing/Blade: Thermalplastic PBT, UL 94V-0  
 Insulation Resistance: 10M $\Omega$ , 500VDC/min between bare wire and frame  
 Dielectric Strength: 5mA max. 500VAC/min between bare wire and frame  
 Operation Temperature: -10°C~70°C(Humidity 35%-85%RH)  
 Storage Temperature: -40°C~80°C(Humidity 35%-85%RH)  
 Lead Wire: UL Type #26 AWG  
 Weight: 53 g      Packing: 400PCS/CTN



Model Number	Voltage (VDC)	Op.Voltage (VDC)	AirFlow (CFM)	StaticPres. (mm-H <sub>2</sub> O)	Noise (dBA)	Speed (RPM)	Current (mA)	Power (W)	Available Bearing	Curves
FD4028B12W3-63	★▲ 12	6.0~13.8	9.20	10.40	36.40	8,000	150	1.80	B	①
FD4028B12W5-63	★▲ 12	6.0~13.8	11.60	15.40	40.40	10,000	250	3.00	B	②
FD4028B12W7-63	★▲ 12	6.0~13.8	14.90	24.40	45.30	13,000	380	4.56	B	③
FD4028B12W9-63	★▲ 12	6.0~13.8	20.40	42.80	53.20	17,500	650	7.80	B	④
FD4028B24W3-63	★▲ 24	12.0~27.6	9.20	10.40	36.40	8,000	100	2.40	B	①
FD4028B24W5-63	★▲ 24	12.0~27.6	11.60	15.40	40.40	10,000	150	3.60	B	②
FD4028B24W7-63	★▲ 24	12.0~27.6	14.90	24.40	45.30	13,000	300	7.20	B	③

- If model depicts "★", auto restart protection function built in.
- If model depicts "▲", polarity protection function built in.

Specifications are subject to change without notice

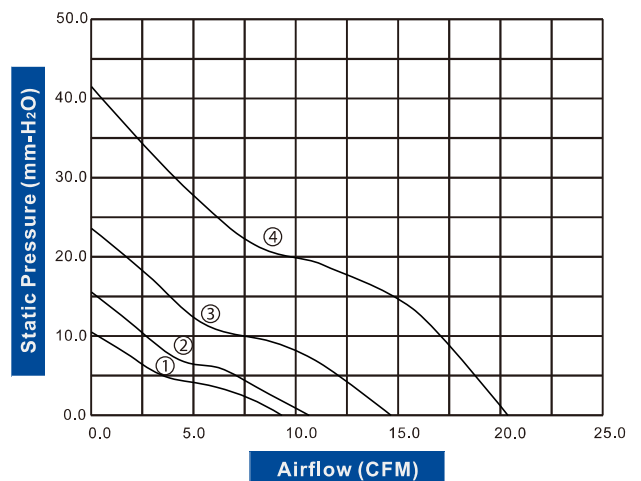
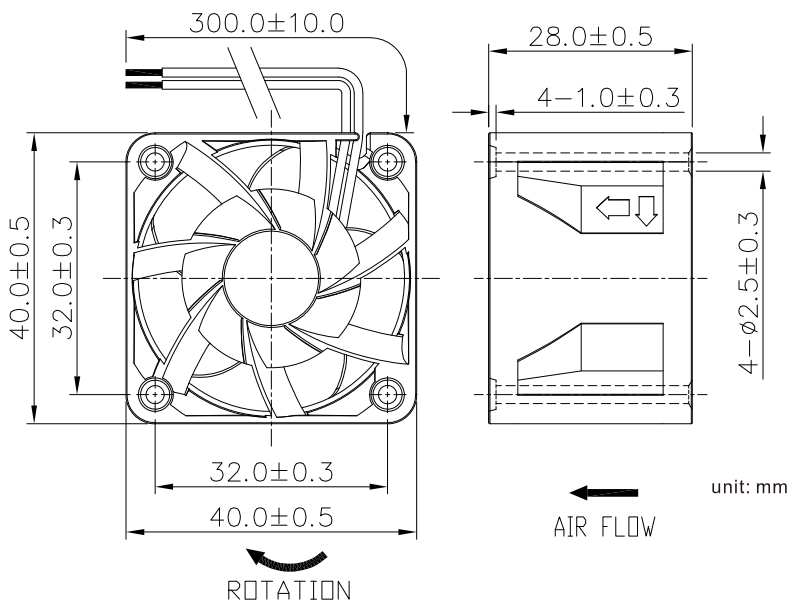



# DC AXIAL FAN 50x50x10mm



Housing/Blade: Thermoplastic PBT, UL 94V-0  
 Insulation Resistance: 10M $\Omega$ , 500VDC/min between bare wire and frame  
 Dielectric Strength: 5mA max. 500VAC/min between bare wire and frame  
 Operation Temperature: -10°C~70°C(Humidity 35%-85%RH)  
 Storage Temperature: -40°C~85°C(Humidity 35%-85%RH)  
 Lead Wire: UL Type #26 AWG  
 Weight: 19 g      Packing: 400PCS/CTN



Model Number	Voltage (VDC)	Op.Voltage (VDC)	AirFlow (CFM)	StaticPres. (mm-H <sub>2</sub> O)	Noise (dBA)	Speed (RPM)	Current (mA)	Power (W)	Available Bearing	Curves
FD5010B05W3-61	★▲ 5	3.5~5.75	8.70	1.60	21.70	3,500	140	0.70	B,S	①
FD5010B05W5-61	★▲ 5	3.5~5.75	11.20	2.50	27.60	4,500	200	1.00	B,S	②
FD5010B05W7-61	★▲ 5	3.5~5.75	13.40	3.30	31.50	5,300	300	1.50	B,S	③
FD5010B12W3-61	★▲ 12	6.0~13.8	8.70	1.60	21.70	3,500	70	0.84	B,S	①
FD5010B12W5-61	★▲ 12	6.0~13.8	11.20	2.50	27.60	4,500	80	0.96	B,S	②
FD5010B12W7-61	★▲ 12	6.0~13.8	13.40	3.30	31.50	5,300	160	1.92	B,S	③

- For "Sleeve" bearing version, change the "B" in the model number to "S" respectively.
- If model depicts "★", auto restart protection function built in.
- If model depicts "▲", polarity protection function built in.

Specifications are subject to change without notice

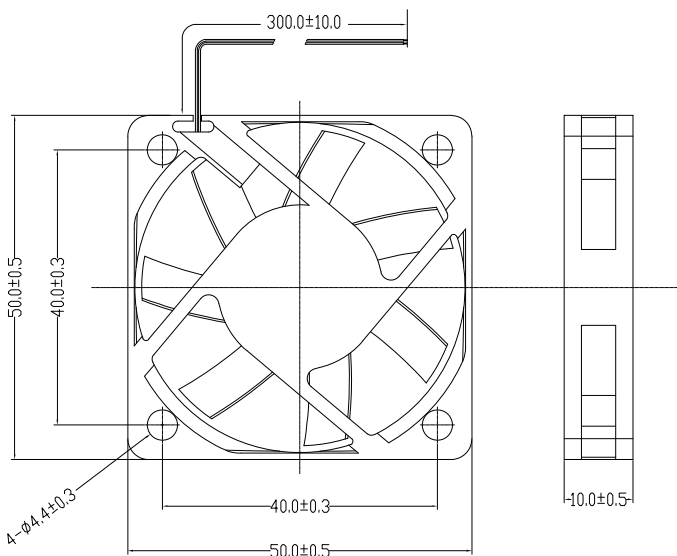

unit: mm

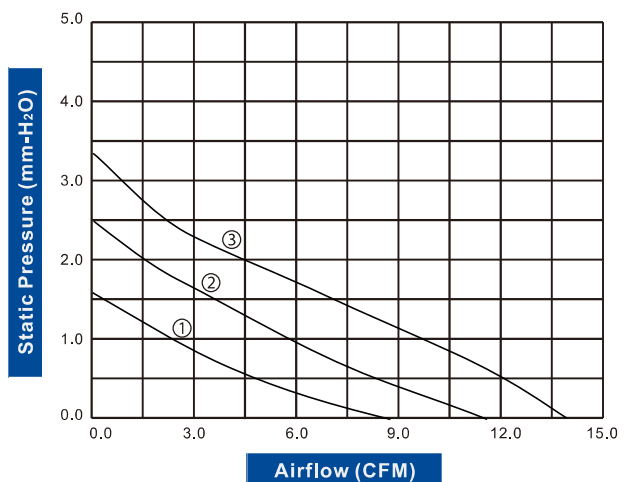

# DC AXIAL FAN 50x50x15mm



Housing/Blade: Thermalplastic PBT, UL 94V-0  
 Insulation Resistance: 10M $\Omega$ , 500VDC/min between bare wire and frame  
 Dielectric Strength: 5mA max. 500VAC/min between bare wire and frame  
 Operation Temperature: -10°C~70°C(Humidity 35%-85%RH)  
 Storage Temperature: -40°C~80°C(Humidity 35%-85%RH)  
 Lead Wire: UL Type #26 AWG  
 Weight: 31 g      Packing: 200PCS/CTN



Model Number	Voltage (VDC)	Op.Voltage (VDC)	AirFlow (CFM)	StaticPres. (mm-H <sub>2</sub> O)	Noise (dBA)	Speed (RPM)	Current (mA)	Power (W)	Available Bearing	Curves
FD5015B05W3-61	★▲ 5	3.5~5.75	11.80	2.70	24.60	4,500	200	1.00	B,S	①
FD5015B05W5-61	★▲ 5	3.5~5.75	13.50	3.50	26.60	5,000	250	1.25	B,S	②
FD5015B05W7-61	★▲ 5	3.5~5.75	14.40	3.70	30.50	5,500	330	1.65	B,S	③
FD5015B12W3-61	★▲ 12	6.0~13.8	11.80	2.70	24.60	4,500	120	1.44	B,S	①
FD5015B12W5-61	★▲ 12	6.0~13.8	13.50	3.50	26.60	5,000	140	1.68	B,S	②
FD5015B12W7-61	★▲ 12	6.0~13.8	14.40	3.70	30.50	5,500	160	1.92	B,S	③
FD5015B24W3-61	★▲ 24	12.0~27.6	11.80	2.70	24.60	4,500	60	1.44	B,S	①
FD5015B24W5-61	★▲ 24	12.0~27.6	13.50	3.50	26.60	5,000	80	1.92	B,S	②
FD5015B24W7-61	★▲ 24	12.0~27.6	14.40	3.70	30.50	5,500	100	2.40	B,S	③

- For "Sleeve" bearing version, change the "B" in the model number to "S" respectively.
- If model depicts "★", auto restart protection function built in.
- If model depicts "▲", polarity protection function built in.

Specifications are subject to change without notice

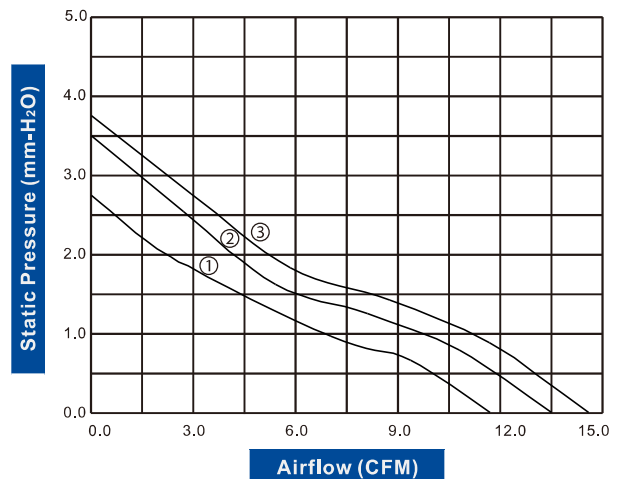
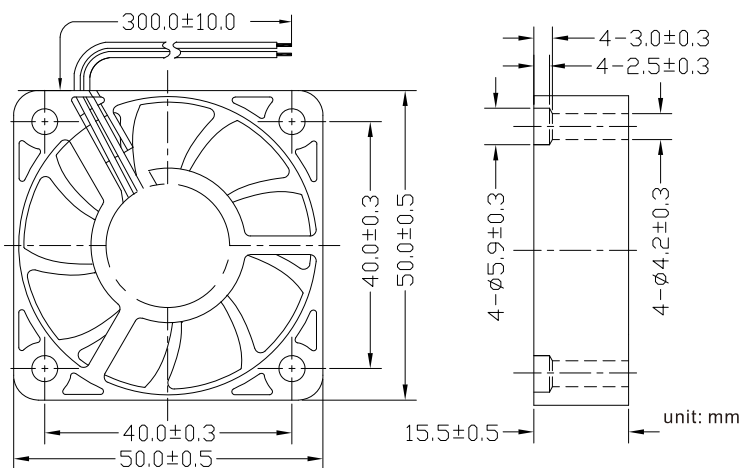

# DC AXIAL FAN 60x60x10mm



Housing/Blade: Thermoplastic PBT, UL 94V-0  
 Insulation Resistance: 10M $\Omega$ , 500VDC/min between bare wire and frame  
 Dielectric Strength: 5mA max. 500VAC/min between bare wire and frame  
 Operation Temperature: -10°C~70°C(Humidity 35%-85%RH)  
 Storage Temperature: -40°C~85°C(Humidity 35%-85%RH)  
 Lead Wire: UL Type #26 AWG  
 Weight: 23 g      Packing: 400PCS/CTN



Model Number	Voltage (VDC)	Op.Voltage (VDC)	Air Flow (CFM)	Static Pres. (mm-H <sub>2</sub> O)	Noise (dBA)	Speed (RPM)	Current (mA)	Power (W)	Available Bearing	Curves
FD6010B05W3-61	★▲ 5	3.5~5.75	12.30	1.40	26.60	3,000	170	0.85	B,S	①
FD6010B05W5-61	★▲ 5	3.5~5.75	16.10	2.50	30.50	3,600	220	1.10	B,S	②
FD6010B05W7-61	★▲ 5	3.5~5.75	18.80	3.20	35.50	4,200	350	1.75	B,S	③
FD6010B12W3-61	★▲ 12	6.0~13.8	12.30	1.40	26.60	3,000	140	1.68	B,S	①
FD6010B12W5-61	★▲ 12	6.0~13.8	16.10	2.50	30.50	3,600	170	2.04	B,S	②
FD6010B12W7-61	★▲ 12	6.0~13.8	12.30	3.20	35.50	4,200	220	2.64	B,S	③
FD6010B24W3-61	★▲ 24	12.0~27.6	12.30	1.40	26.60	3,000	70	1.68	B,S	①
FD6010B24W5-61	★▲ 24	12.0~27.6	16.10	2.50	30.50	3,600	90	2.16	B,S	②
FD6010B24W7-61	★▲ 24	12.0~27.6	18.80	3.20	35.50	4,200	110	2.64	B,S	③

- For "Sleeve" bearing version, change the "B" in the model number to "S" respectively.
- If model depicts "★", auto restart protection function built in.
- If model depicts "▲", polarity protection function built in.

Specifications are subject to change without notice

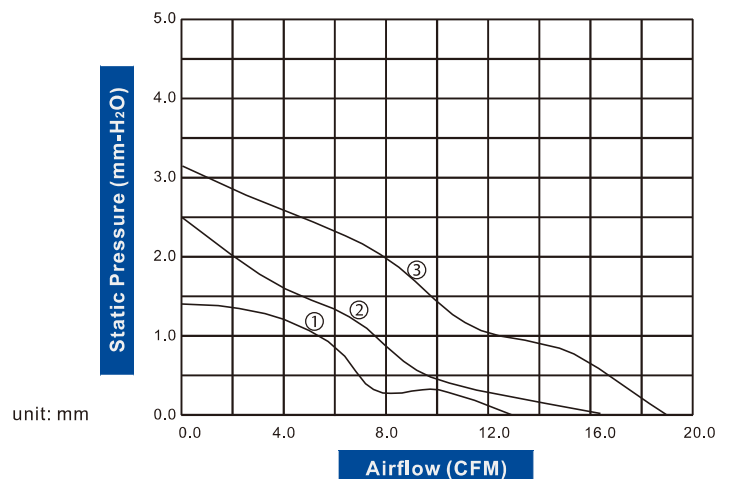
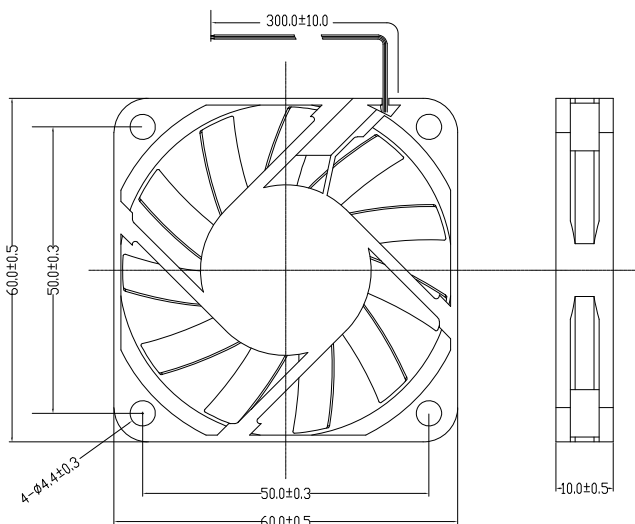

# DC AXIAL FAN 60x60x20mm



Housing/Blade: Thermalplastic PBT, UL 94V-0  
 Insulation Resistance: 10M $\Omega$ , 500VDC/min between bare wire and frame  
 Dielectric Strength: 5mA max. 500VAC/min between bare wire and frame  
 Operation Temperature: -10°C~70°C(Humidity 35%-85%RH)  
 Storage Temperature: -40°C~80°C(Humidity 35%-85%RH)  
 Lead Wire: UL Type #24 AWG  
 Weight: 50 g      Packing: 200PCS/CTN



Model Number	Voltage (VDC)	Op.Voltage (VDC)	AirFlow (CFM)	StaticPres. (mm-H <sub>2</sub> O)	Noise (dBA)	Speed (RPM)	Current (mA)	Power (W)	Available Bearing	Curves
FD6020B12W3-61	★▲	12	6.0~13.8	15.90	2.40	25.60	3,000	80	0.96	B,S ①
FD6020B12W5-61	★▲	12	6.0~13.8	18.80	3.30	28.60	3,500	120	1.44	B,S ②
FD6020B12W7-61	★▲	12	6.0~13.8	22.60	4.80	34.50	4,200	160	1.92	B,S ③
FD6020B24W3-61	★▲※	24	12.0~27.6	15.90	2.40	25.60	3,000	80	1.92	B,S ①
FD6020B24W5-61	★▲※	24	12.0~27.6	18.80	3.30	28.60	3,500	100	2.40	B,S ②
FD6020B24W7-61	★▲※	24	12.0~27.6	22.60	4.80	34.50	4,200	130	3.12	B,S ③

- For "Sleeve " bearing version, change the "B" in the model number to "S" respectively.
- If model depicts "★", auto restart protection function built in.
- If model depicts "▲", polarity protection function built in.
- If model depicts "※", UL and TUV approvals can be implemented upon request.

Specifications are subject to change without notice

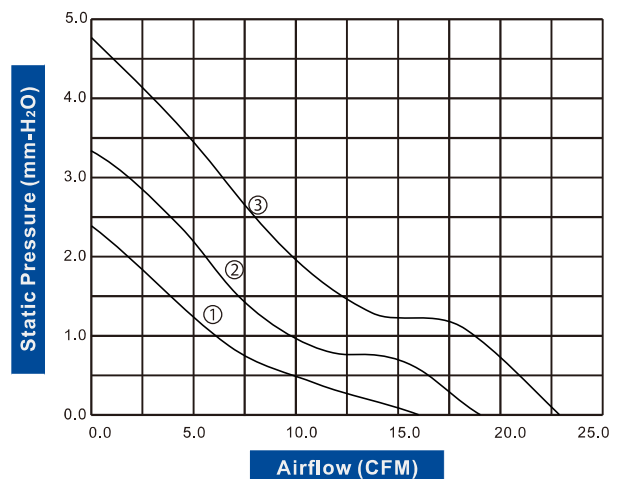
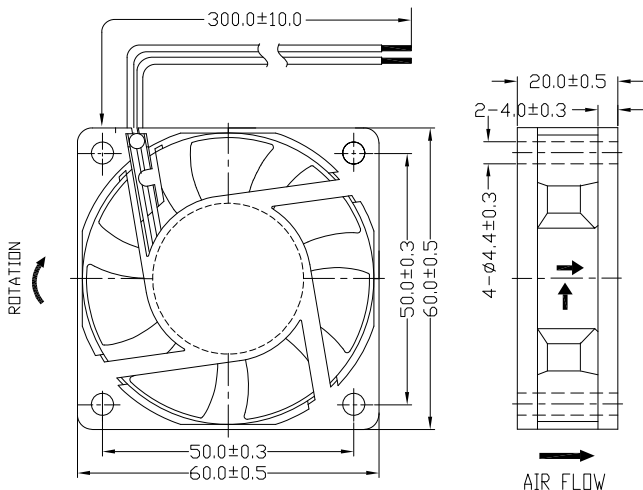

# DC AXIAL FAN 60x60x25mm



Housing/Blade: Thermalplastic PBT, UL 94V-0  
 Insulation Resistance: 10M $\Omega$ , 500VDC/min between bare wire and frame  
 Dielectric Strength: 5mA max. 500VAC/min between bare wire and frame  
 Operation Temperature: -10°C~70°C(Humidity 35%-85%RH)  
 Storage Temperature: -40°C~80°C(Humidity 35%-85%RH)  
 Lead Wire: UL Type #24 AWG  
 Weight: 62 g      Packing: 200PCS/CTN



Model Number	Voltage (VDC)	Op.Voltage (VDC)	AirFlow (CFM)	StaticPres. (mm-H <sub>2</sub> O)	Noise (dBA)	Speed (RPM)	Current (mA)	Power (W)	Available Bearing	Curves	
FD6025B12W3-61A	★▲	12	6.0~13.8	12.70	1.80	21.70	2,500	70	0.84	B,S	①
FD6025B12W5-61A	★▲	12	6.0~13.8	15.30	2.60	23.60	3,000	100	1.20	B,S	②
FD6025B12W7-61A	★▲	12	6.0~13.8	20.60	4.60	28.60	4,000	140	1.68	B,S	③
FD6025B24W3-61A	★▲	24	12.0~27.6	12.70	1.80	21.70	2,500	90	2.16	B,S	①
FD6025B24W5-61A	★▲	24	12.0~27.6	15.30	2.60	23.60	3,000	100	2.40	B,S	②
FD6025B24W7-61A	★▲	24	12.0~27.6	20.60	4.60	28.60	4,000	140	3.36	B,S	③
FD6025B48W3-61A	★▲	48	24.0~55.2	26.00	7.10	36.40	5,000	100	4.80	B,S	④
FD6025B48W5-61A	★▲	48	24.0~55.2	31.40	9.70	39.40	6,000	120	5.76	B,S	⑤
FD6025B48W7-61A	★▲	48	24.0~55.2	39.40	14.70	46.30	7,500	180	8.64	B,S	⑥
FD6025B60W3-61A	★▲※	60	36.0~72.0	26.00	7.10	36.40	5,000	200	12.00	B	④

- For "Sleeve" bearing version, change the "B" in the model number to "S" respectively.
- If model depicts "★", auto restart protection function built in.
- If model depicts "▲", polarity protection function built in.
- If model depicts "※", TUV approvals can be implemented upon request.

Specifications are subject to change without notice

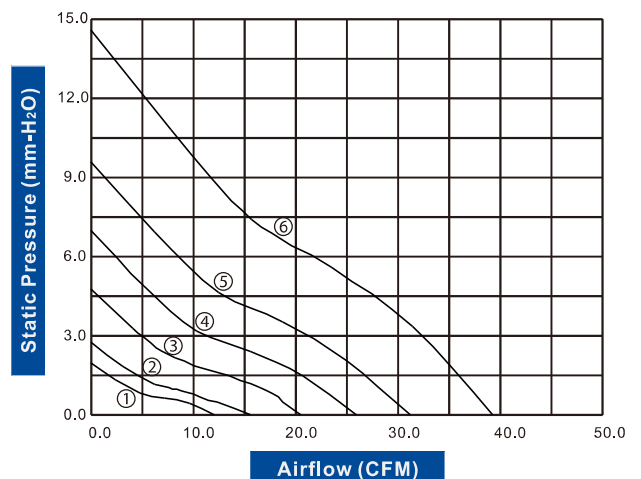
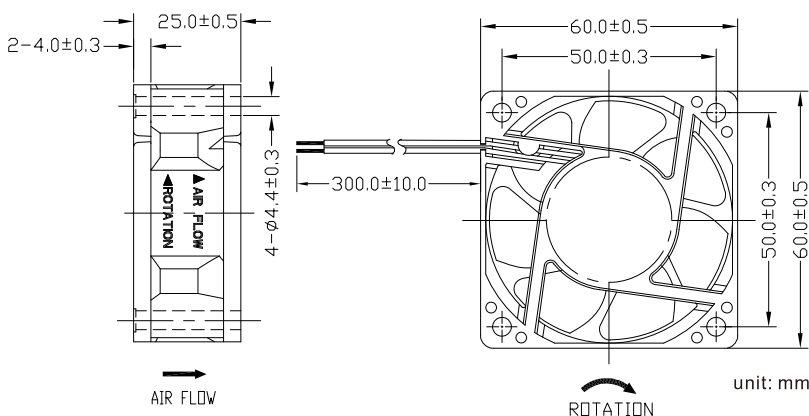

# DC AXIAL FAN 80x80x38mm



Housing/Blade: Thermalplastic PBT, UL 94V-0  
 Insulation Resistance: 10M $\Omega$ , 500VDC/min between bare wire and frame  
 Dielectric Strength: 5mA max. 500VAC/min between bare wire and frame  
 Operation Temperature: -10°C~70°C(Humidity 35%-85%RH)  
 Storage Temperature: -40°C~80°C(Humidity 35%-85%RH)  
 Lead Wire: UL Type #24 AWG  
 Weight: 180 g      Packing: 60PCS/CTN



DC Axial Fans

Model Number	Voltage (VDC)	Op.Voltage (VDC)	AirFlow (CFM)	StaticPres. (mm-H <sub>2</sub> O)	Noise (dBA)	Speed (RPM)	Current (mA)	Power (W)	Available Bearing	Curves
FD8038B12W3-63	★▲ 12	6.0~13.8	62.40	12.60	48.30	4,500	450	5.40	B	①
FD8038B12W5-63	★▲ 12	6.0~13.8	84.70	22.10	56.10	6,000	850	10.20	B	②
FD8038B12W7-63	★▲ 12	6.0~13.8	106.80	35.30	62.10	7,500	1550	18.60	B	③
FD8038B12W9-63	★▲ 12	6.0~13.8	125.10	50.80	66.00	9,000	2800	33.60	B	④
FD8038B24W3-63	★▲ 24	12.0~27.6	62.40	12.60	48.30	4,500	250	6.00	B	①
FD8038B24W5-63	★▲ 24	12.0~27.6	84.70	22.10	56.10	6,000	450	10.80	B	②
FD8038B24W7-63	★▲ 24	12.0~27.6	106.80	35.30	62.10	7,500	780	18.72	B	③
FD8038B24W9-63	★▲ 24	12.0~27.6	125.10	50.80	66.00	9,000	1400	33.60	B	④
FD8038B48W3-63	★▲ 48	24.0~55.2	62.40	12.60	48.30	4,500	180	8.64	B	①
FD8038B48W5-63	★▲ 48	24.0~55.2	84.70	22.10	56.10	6,000	280	13.44	B	②
FD8038B48W7-63	★▲ 48	24.0~55.2	106.80	35.30	62.10	7,500	450	21.60	B	③
FD8038B48W9-63	★▲ 48	24.0~55.2	125.10	50.80	66.00	9,000	750	36.00	B	④

- If model depicts "★", auto restart protection function built in.
- If model depicts "▲", polarity protection function built in.

Specifications are subject to change without notice

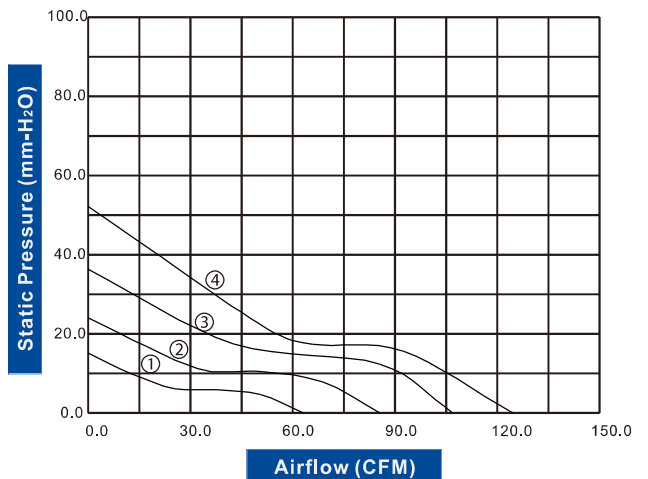
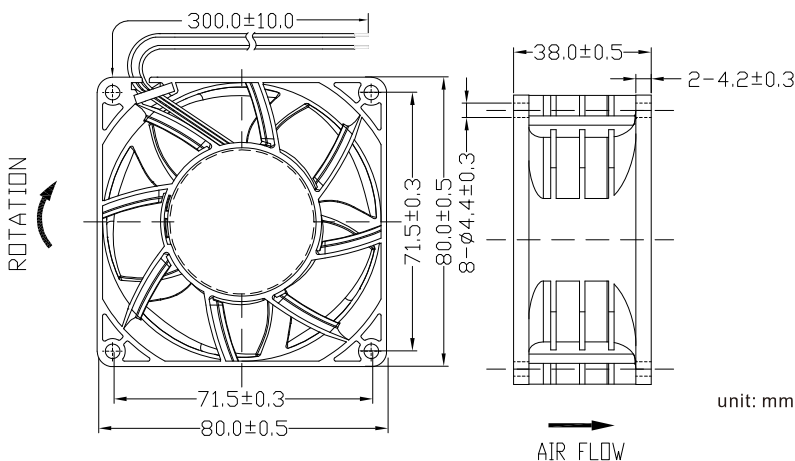

# DC AXIAL FAN 92x92x25mm



Housing/Blade: Thermalplastic PBT, UL 94V-0  
 Insulation Resistance: 10M $\Omega$ , 500VDC/min between bare wire and frame  
 Dielectric Strength: 5mA max. 500VAC/min between bare wire and frame  
 Operation Temperature: -10°C~70°C(Humidity 35%-85%RH)  
 Storage Temperature: -40°C~80°C(Humidity 35%-85%RH)  
 Lead Wire: UL Type #24 AWG  
 Weight: 85 g      Packing: 100PCS/CTN



Model Number	Voltage (VDC)	Op.Voltage (VDC)	AirFlow (CFM)	StaticPres. (mm-H <sub>2</sub> O)	Noise (dBA)	Speed (RPM)	Current (mA)	Power (W)	Available Bearing	Curves
FD9225B12W3-61	★▲ 12	6.0~13.8	37.70	2.30	28.60	2,000	160	1.92	B,S	①
FD9225B12W5-61	★▲ 12	6.0~13.8	47.70	3.20	33.50	2,500	190	2.28	B,S	②
FD9225B12W7-61	★▲ 12	6.0~13.8	53.10	4.10	36.40	2,800	230	2.76	B,S	③
FD9225B24W3-61	★▲ 24	12.0~27.6	37.70	2.30	28.60	2,000	150	3.60	B,S	①
FD9225B24W5-61	★▲ 24	12.0~27.6	47.70	3.20	33.50	2,500	180	4.32	B,S	②
FD9225B24W7-61	★▲ 24	12.0~27.6	53.10	4.10	36.40	2,800	220	5.28	B,S	③

- For "Sleeve" bearing version, change the "B" in the model number to "S" respectively.
- If model depicts "★", auto restart protection function built in.
- If model depicts "▲", polarity protection function built in.

Specifications are subject to change without notice

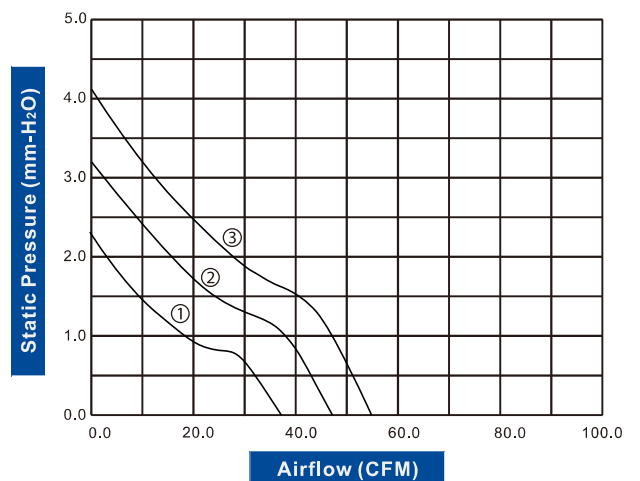
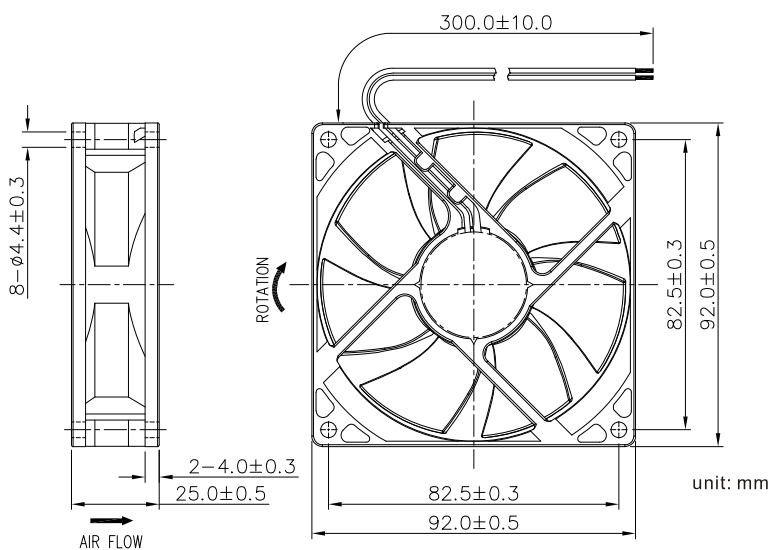

# AC AXIAL FAN 172x150x51mm



**Housing:** Die-Cast Aluminum, Painted Black  
**Blade:** Thermoplastic PBT, UL 94V-0  
**Insulation Resistance:** 100M $\Omega$ , 500VDC/min between bare wire and frame  
**Dielectric Strength:** 1500VAC for one minute  
**Operation Temperature:** -10°C~65°C(Humidity 35%-85%RH)  
**Storage Temperature:** -40°C~75°C(Humidity 35%-85%RH)  
**Lead Wire:** UL Type #22 AWG  
**Weight:** 970 g      **Packing:** 16PCS/CTN



Model Number	Voltage (VAC)	Frequency (Hz)	AirFlow (CFM)	Stat.Pres. (mm-H <sub>2</sub> O)	Noise (dBA)	Speed (RPM)	Current (mA)	Power (W)	Available Bearing	Curves
FA1751B11T5C-31 ※	115	50/60	213.2/248.7	12.2/13.2	53.8/55.8	2500/2800	260/290	39/40	B	①/②
FA1751B11T7C-31 ※	115	50/60	253.8/297.4	16.2/20.3	55.2/60.1	2,850/3,300	350/400	46/50	B	③/④
FA1751B22T5C-31	230	50/60	213.2/248.7	12.2/12.2	53.8/55.8	2500/2800	140/150	42/43	B	①/②
FA1751B22T7C-31	230	50/60	253.8/297.4	16.2/20.3	55.2/60.1	2,850/3,300	200/220	46/50	B	③/④

- For "Wire Lead" version, change the "T" in the model number to "W".
- If model depicts "※", TUV approvals can be implemented upon request.

Specifications are subject to change without notice

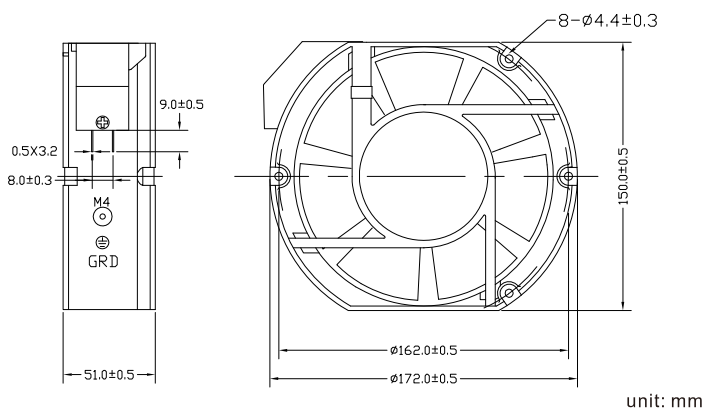

unit: mm

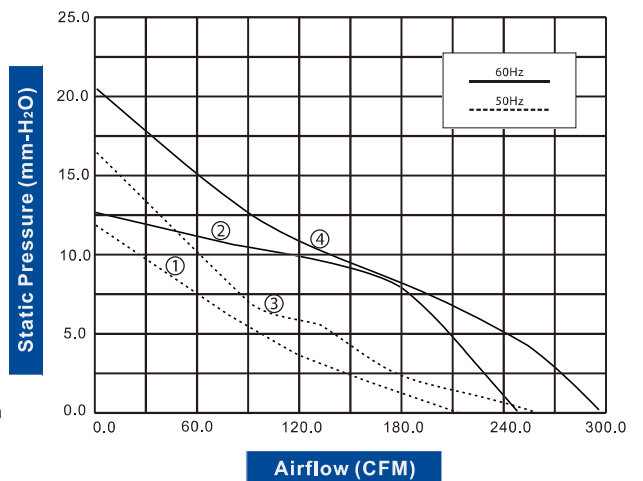



# AC AXIAL FAN Ø 220x60mm



**Housing:** Die-Cast Aluminum, Painted Black  
**Blade:** Thermoplastic PBT, UL 94V-0  
**Insulation Resistance:** 100M $\Omega$ , 500VDC/min between bare wire and frame  
**Dielectric Strength:** 1500VAC for one minute  
**Operation Temperature:** -10°C~70°C(Humidity 35%-85%RH)  
**Storage Temperature:** -40°C~85°C(Humidity 35%-85%RH)  
**Motor Protection:** Thermally Protected  
**Weight:** 1540 g      **Packing:** 10PCS/CTN



Model Number	Voltage (VAC)	Frequency (Hz)	Air Flow (CFM)	Stat.Pres. (mm-H <sub>2</sub> O)	Noise (dBA)	Speed (RPM)	Current (mA)	Power (W)	Available Bearing	Curves
FA2260B11T7C-31	115	50/60	436.5/492.3	24.4/18.3	58.1/61.1	2,800/3,200	420/460	50/56	B	①/②
FA2260B22T7C-31	230	50/60	436.5/492.3	24.4/18.3	58.1/61.1	2,800/3,200	250/260	50/56	B	①/②

• For "Wire Lead" version, change the "T" in the model number to "W".

Specifications are subject to change without notice

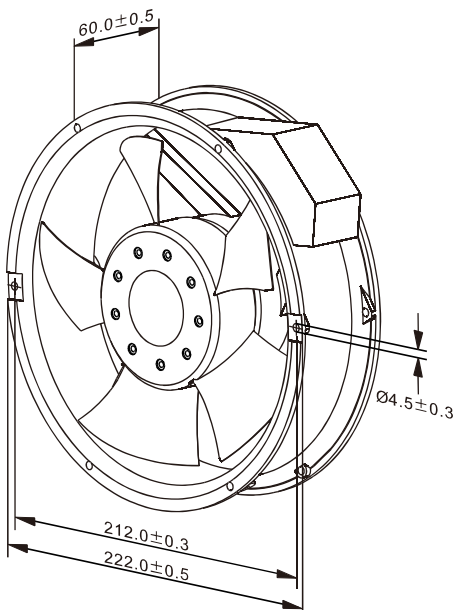

unit: mm

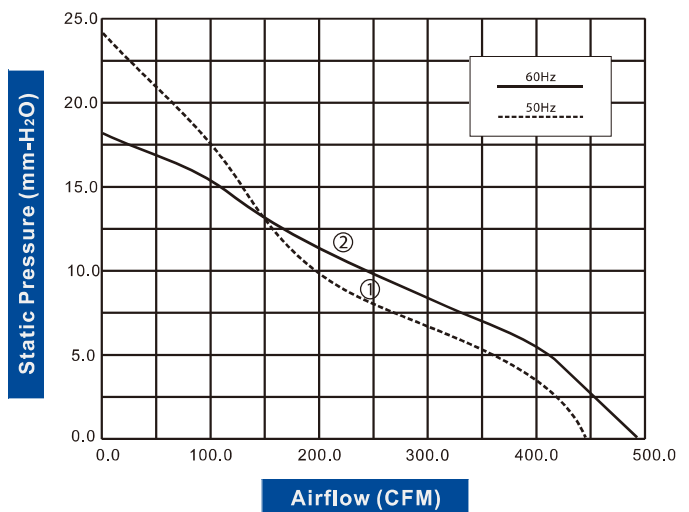

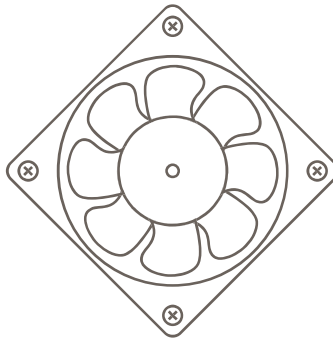

**COOLTRON**<sup>®</sup>  
*www.cooltron.com*

**USA**

19929 Harrison Ave.  
City of Industry, CA 91789  
Tel: +1-909-598-6033  
Fax: +1-909-598-6043

**CHINA**

2/F, Building D, Anfeng Industrial Park,  
Dalang Street, Longhua District,  
Shenzhen, China.  
Tel: +86-755-8209-0805  
Fax: +86-755-2904-3077